

# YSI25 SERIES

## 25W

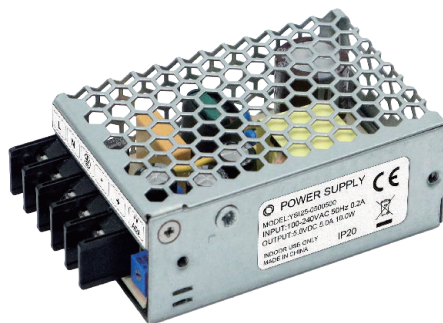

YSI series power supplies use advanced switching power supply technology and provide stable DC output to meet the power requirements of various devices.

They have multiple protective functions, such as short - circuit, overload and over - voltage protection, ensuring the safe operation of power supplies and devices.

Their natural air - cooling heat dissipation method effectively reduces temperature during operation, thus prolonging the service life.

RoHS

UK  
CA

CE

UL  
LISTED  
E526868

Pending

## Features

- Universal AC Input/ Full Range
- Protections: Short circuit /Overload /Over voltage
- Cooling by free air convection
- High efficiency up to 89%
- No load power consumption<0.5W
- High operating temperature up to 70°C
- LED indicator for power on
- Three years warranty

## Model Description

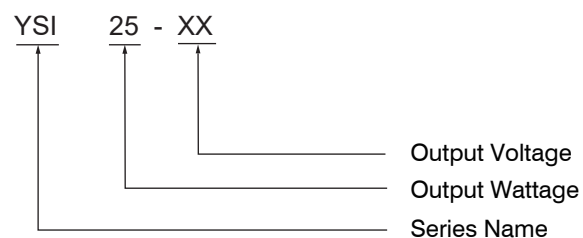

## Model Information

Part number	DC Voltage	Rated Current(max.)	Rated Power	Average Efficiency	Ripple & Noise	Max Capacitive Load	Voltage ADJ Range
YSI25-3.3	3.3V	6A	19.8W	84%	80mVp-p	10000uF	2.85~3.6V
YSI25-5	5V	5A	25W	85.5%	80mVp-p	8000uF	4.75~5.5V
YSI25-12	12V	2.1A	25.2W	85%	120mVp-p	1500uF	10.8~13.2V
YSI25-15	15V	1.7A	25.5W	84.5%	120mVp-p	1000uF	13.5~16.5V
YSI25-24	24V	1.1A	26.4W	86%	120mVp-p	750uF	22~27.6V
YSI25-48	48V	0.57A	27.36W	86%	200mVp-p	220uF	42~54V

# YSI25 SERIES

## 25W

### Specification

Model	Safety Model No.	YSI25-X
Output	Setup,Rise,Hold up Time	1.8s,23ms,80ms/230VAC(at full load) 4.0s,80ms,14ms/115VAC(at full load)
	Voltage Tolerance	± 3.0% YSI25-3.3 ± 2.0% YSI25-5 ± 1.0% YSI25-12/15/24/48
	Line Regulation	± 0.5%
	Load Regulation	± 2.0% YSI25-3.3 ± 1.0% YSI25-5 ± 0.5% YSI25-12/15/24/48
Input	Rated Voltage Range	100-240VAC
	Voltage Range	90-264VAC/127-370VDC
	Frequency Range	50/60Hz
	AC Current	0.6A/115VAC 0.2A/230VAC
	Inrush Current	Cold Start 45A/240us at 230VAC 50Hz
	Leakage Current	<2mA/240VAC
Protection	Over Load	110~180%Rated Output Power Hiccup mode, recovers automatically after fault condition is removed.
	Short Circuit	Hiccup mode, recovers automatically after fault condition is removed.
	Over Voltage	115~135%Rated Output Voltage
		Shut down o/p voltage, re-power on to recover.
Ambient	Working TEMP.	-20 ~ +70 ℃ (Please refer to "Derating Curve" section)
	Working Humidity	20 ~ 95%RH Non-condensing
	Storage TEMP. Humidity	-40 ~ +85 ℃, 10 ~ 95%RH Non-condensing
	TEMP. Coefficient	± 0.03%/ (0 ~ 50 ℃) on load output
	Vibration	Component: 10 ~ 500Hz, 5G 10min./1cycle, 60min. each along X, Y, Z axes
	Safety Protection	Class I
	Over Voltage Category	OVC II/ According to EN62368-1; altitude up to 2000 meters
Safety	Safety Standards	EN62368-1 approved
	Withstand Voltage	I/P-O/P:3KVAC/1min I/P-FG:2KVAC/1min O/P-FG:0.5KVAC/1min
	Isolation Resistance	I/P-O/P:100M Ohms / 500VDC / 25 ℃ / 70% RH
EMC	EMC EMISSION	Compliance to BS EN/EN55032 (CISPR32) Class B,BS EN/EN55035 BS EN/EN61000-3-2 Class A-D,BS EN/EN61000-3-3
	EMC IMMUNITY	Compliance to BS EN/EN61000-4-11 Criteria B, BS EN/EN61000-4-2,3,4,5,6,8 Criteria A
Others	Packing	140g/pcs; 32.5 x 22.5 x 20.5 cm; 50pcs/carton
	Dimension (LxWxH)	78 x 51 x 28 mm
	MTBF	356.4Khrs min. MIL-HDBK-217F(25 ℃)
	Housing material	Aluminium / iron
Note	1.All parameters NOT specially mentioned are measured at 115/230VAC input, rated load and 25 ℃ of ambient temperature. 2.Ripple&noise are measured at 20MHz of bandwidth by using a 12" twisted pair-wire terminated with a 0.1uf & 47uf parallel capacitor. 3.The power supply is considered a component which will be installed into a final equipment. The final equipment must be re-confirmed that it still meets EMC directives. 4.Derating may be needed under low input voltages. Please check the derating curve for more details. 5.Strongly recommended that external output capacitance should not exceed 10000uF(Only for the models with output voltage 5/12V) 6.The ambient temperature derating of 3.5 ℃/1000m with fanless models and of 5 ℃/1000m with fan models for operating altitude higher than 2000m(6500ft).	

# YSI25 SERIES

## 25W

### Drawing & Label

(Unit: mm , tolerance:  $\pm 1\text{mm}$ )

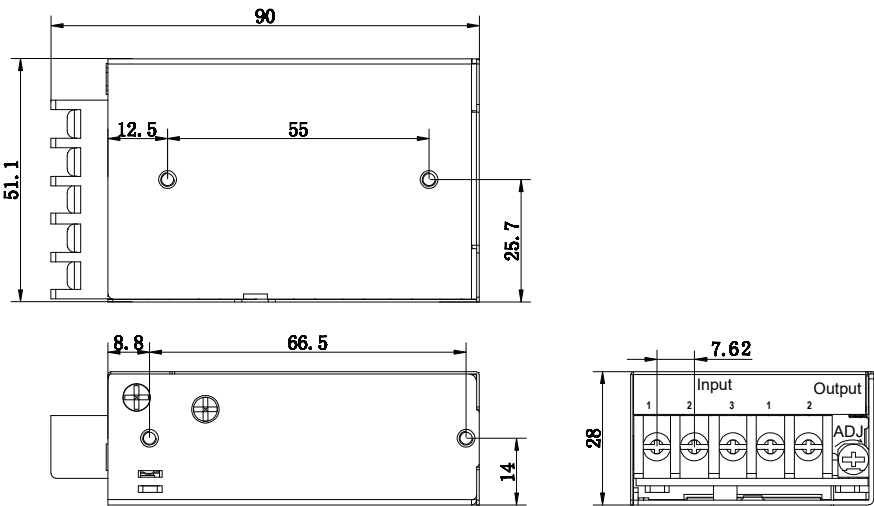

AC Input Terminal pin NO.Assignment

Pin No.	Assignment	Terminal	Max mounting torque
1	AC/L	B762C-03-05P-KC	0.8N-m
2	AC/N		
3	$\oplus$		

DC Output Terminal pin NO.Assignment

Pin No.	Assignment	Terminal	Max mounting torque
1	-V	B762C-03-05P-KC	0.8N-m
2	+V		

### Block Diagram

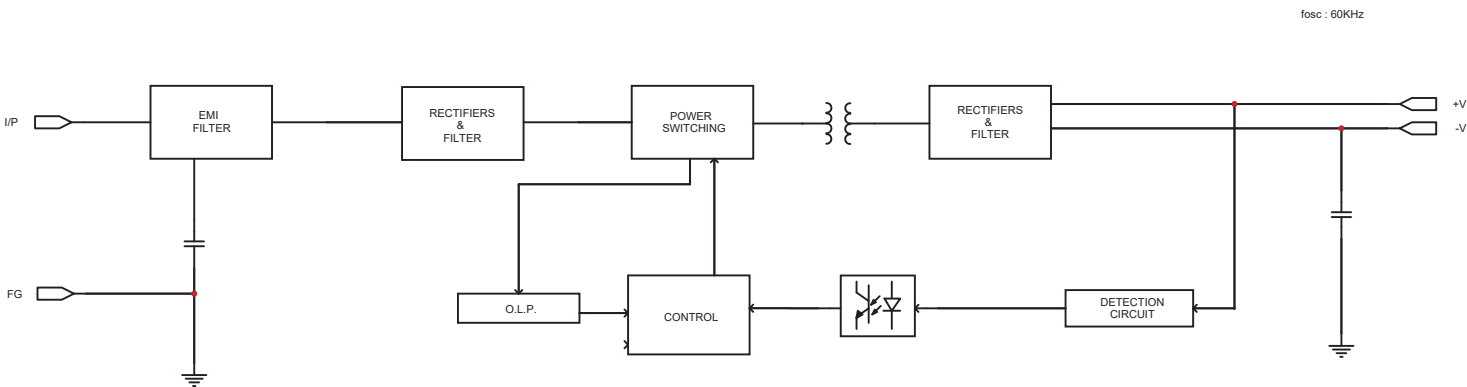

# YSI25 SERIES

## 25W

### Engineering Data

Derating Curve

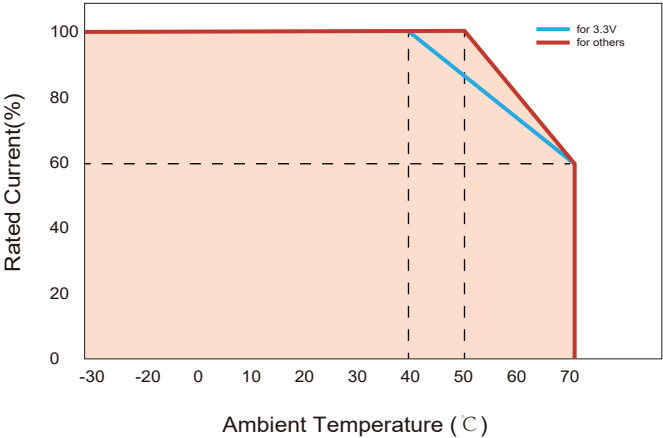

Static Characteristics

